

SAGES SCIENTIFIC SESSION & POSTGRAD

APRIL 3 -5, 2019

BALTIMORE CONVENTION CENTER - EXHIBITION HALLS E - G - BALTIMORE, MD

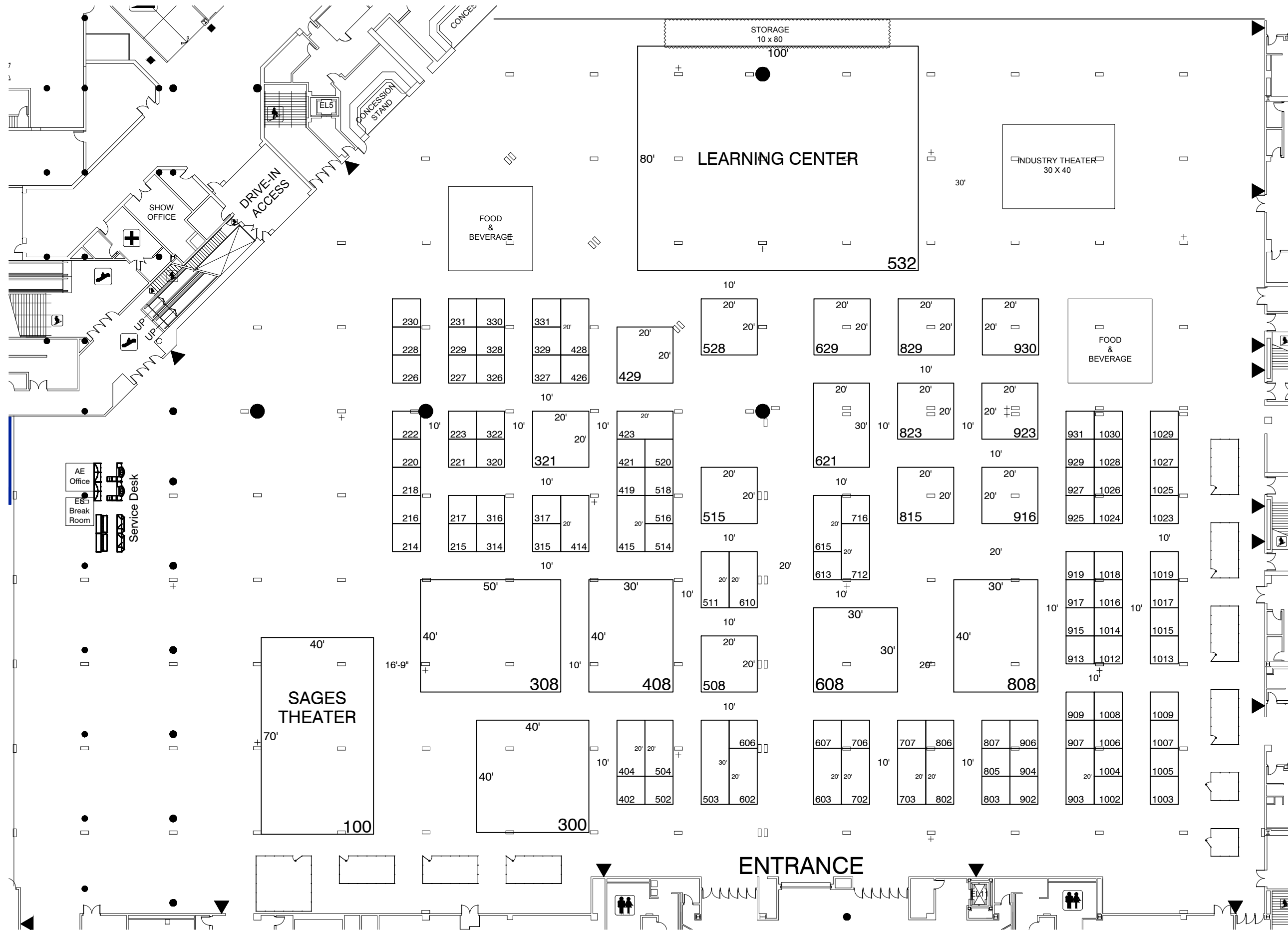

REVISION
Date: 12/14/2018
By: DOMINIQUE SAUTIER, NERDC

BOOTH COUNT

Dimension	Size	Qty	SqFt
10x10'	100	83	8,300
10x20'	200	16	3,200
10x30'	300	1	300
20x20'	400	12	4,800
20x30'	500	1	600
30x30'	900	1	900
30x40'	1,200	2	2,400
40x40'	1,600	1	1,600
40x50'	2,000	1	2,000
40x70'	2,800	1	2,800
80x100'	8,000	1	8,000
Totals:	120	120	34,900

BLDG. LEGEND:

Symbol	Description
--- (dashed line)	VISIBLE WALL
--- (solid line)	11' 0" CEILING HEIGHT
--- (dotted line)	14' 0" CEILING HEIGHT
--- (dash-dot line)	16' 0" CEILING HEIGHT
--- (long-dash line)	18' 0" CEILING HEIGHT
--- (short-dash line)	20' 0" CEILING HEIGHT
--- (dash-dot-dot line)	22' 0" CEILING HEIGHT
--- (long-dash-dot line)	24' 0" CEILING HEIGHT
--- (dash-dot-dot-dot line)	26' 0" CEILING HEIGHT
--- (long-dash-dot-dot line)	28' 0" CEILING HEIGHT
--- (dash-dot-dot-dot-dot line)	30' 0" CEILING HEIGHT
--- (long-dash-dot-dot-dot line)	32' 0" CEILING HEIGHT
--- (dash-dot-dot-dot-dot-dot line)	34' 0" CEILING HEIGHT
--- (long-dash-dot-dot-dot-dot line)	36' 0" CEILING HEIGHT
--- (dash-dot-dot-dot-dot-dot-dot line)	38' 0" CEILING HEIGHT
--- (long-dash-dot-dot-dot-dot-dot line)	40' 0" CEILING HEIGHT
--- (dash-dot-dot-dot-dot-dot-dot-dot line)	42' 0" CEILING HEIGHT
--- (long-dash-dot-dot-dot-dot-dot-dot line)	44' 0" CEILING HEIGHT
--- (dash-dot-dot-dot-dot-dot-dot-dot-dot line)	46' 0" CEILING HEIGHT
--- (long-dash-dot-dot-dot-dot-dot-dot-dot line)	48' 0" CEILING HEIGHT
--- (dash-dot-dot-dot-dot-dot-dot-dot-dot-dot line)	50' 0" CEILING HEIGHT
--- (long-dash-dot-dot-dot-dot-dot-dot-dot-dot line)	52' 0" CEILING HEIGHT
--- (dash-dot-dot-dot-dot-dot-dot-dot-dot-dot-dot line)	54' 0" CEILING HEIGHT
--- (long-dash-dot-dot-dot-dot-dot-dot-dot-dot-dot line)	56' 0" CEILING HEIGHT
--- (dash-dot-dot-dot-dot-dot-dot-dot-dot-dot-dot-dot line)	58' 0" CEILING HEIGHT
--- (long-dash-dot-dot-dot-dot-dot-dot-dot-dot-dot-dot-dot line)	60' 0" CEILING HEIGHT
--- (dash-dot-dot-dot-dot-dot-dot-dot-dot-dot-dot-dot-dot line)	62' 0" CEILING HEIGHT
--- (long-dash-dot-dot-dot-dot-dot-dot-dot-dot-dot-dot-dot-dot line)	64' 0" CEILING HEIGHT
--- (dash-dot-dot-dot-dot-dot-dot-dot-dot-dot-dot-dot-dot-dot line)	66' 0" CEILING HEIGHT
--- (long-dash-dot-dot-dot-dot-dot-dot-dot-dot-dot-dot-dot-dot-dot line)	68' 0" CEILING HEIGHT
--- (dash-dot-dot-dot-dot-dot-dot-dot-dot-dot-dot-dot-dot-dot-dot line)	70' 0" CEILING HEIGHT
--- (long-dash-dot-dot-dot-dot-dot-dot-dot-dot-dot-dot-dot-dot-dot-dot line)	72' 0" CEILING HEIGHT
--- (dash-dot-dot-dot-dot-dot-dot-dot-dot-dot-dot-dot-dot-dot-dot-dot line)	74' 0" CEILING HEIGHT
--- (long-dash-dot-dot-dot-dot-dot-dot-dot-dot-dot-dot-dot-dot-dot-dot-dot line)	76' 0" CEILING HEIGHT
--- (dash-dot-dot-dot-dot-dot-dot-dot-dot-dot-dot-dot-dot-dot-dot-dot-dot line)	78' 0" CEILING HEIGHT
--- (long-dash-dot-dot-dot-dot-dot-dot-dot-dot-dot-dot-dot-dot-dot-dot-dot-dot line)	80' 0" CEILING HEIGHT
--- (dash-dot-dot-dot-dot-dot-dot-dot-dot-dot-dot-dot-dot-dot-dot-dot-dot-dot line)	82' 0" CEILING HEIGHT
--- (long-dash-dot-dot-dot-dot-dot-dot-dot-dot-dot-dot-dot-dot-dot-dot-dot-dot-dot line)	84' 0" CEILING HEIGHT
--- (dash-dot-dot-dot-dot-dot-dot-dot-dot-dot-dot-dot-dot-dot-dot-dot-dot-dot-dot line)	86' 0" CEILING HEIGHT
--- (long-dash-dot-dot-dot-dot-dot-dot-dot-dot-dot-dot-dot-dot-dot-dot-dot-dot-dot-dot line)	88' 0" CEILING HEIGHT
--- (dash-dot-dot-dot-dot-dot-dot-dot-dot-dot-dot-dot-dot-dot-dot-dot-dot-dot-dot-dot line)	90' 0" CEILING HEIGHT
--- (long-dash-dot-dot-dot-dot-dot-dot-dot-dot-dot-dot-dot-dot-dot-dot-dot-dot-dot-dot-dot line)	92' 0" CEILING HEIGHT
--- (dash-dot line)	94' 0" CEILING HEIGHT
--- (long-dash-dot line)	96' 0" CEILING HEIGHT
--- (dash-dot line)	98' 0" CEILING HEIGHT
--- (long-dash-dot line)	100' 0" CEILING HEIGHT

DRAWING INFO

Passport Line Item Number:
#4664256
Facility:
BALTIMORE CONVENTION CENTER
Hall / Level:
EXHIBITION HALLS E - G
City & State:
BALTIMORE, MD
Scale: CUSTOM
Job #: 469467
AE: TONY BUONACORSI
Prod. AE: TONY BUONACORSI
Started: 10/22/2018
Started By: DOMINIQUE SAUTIER, NERDC
Prod. Branch: FREEMAN WASHINGTON

FREEMAN

Disclaimer - Every effort has been made to ensure the accuracy of all information contained on this floor plan. However, no warranties, either expressed or implied, are made with respect to this floor plan. If the location of building columns, utilities or other architectural components of the facility is a consideration in the construction or usage of an exhibit, it is the sole responsibility of the exhibitor to physically inspect the facility to verify all dimension and locations.
© Copyright 2007, Freeman Co. All rights reserved.

Confidential and Proprietary - the information contained herein is the proprietary information of Freeman and by accessing the information, the recipient agrees to keep the information confidential and not disclose it to any third party without the prior consent of Freeman. Recipient also agrees to only use the information for its internal evaluation purposes and for no other purpose, without the prior consent of Freeman.

File Path: P:\Avon\BRANCH\NERDC\Floor Plans\Shows\1904\SAGES - 469467\SSSP - 0419.dwg | Tab Name: EXHIBIT